

Casper

Design – Allermuir

Casper is a stylish and contemporary café plastic monoshell chair, with the option of an upholstered seat designed for all manner of hospitality environments in both corporate and leisure markets. Casper is also an ideal meeting chair, due to the added option of a four leg or sled base frame.



standard & optional features

● Standard feature
□ Not available

	CS1	CS1A	CS2	CS2A	CS5BS	CS9BS	CS7BS	CSTROLLEY
	Side Chair Skid Base	Armchair Skid Base	Side Chair 4 Leg Frame	Armchair 4 Leg Frame	High Stool Low Back 4 Leg Frame	High Stool Low Back Skid Base	High Stool High Back 4 Leg Frame	Stacking Trolley
Weight	16lbs	17lbs	13lbs	15lbs	16lbs	21lbs	22lbs	□
Stacks (on trolley)	25 high	25 high	18 high	18 high	□	□	□	□
Plastic shell - Colors: Back to Black, Slate Gray, Smoke Gray, White as Snow, Turtle Dove, Vintage Red, Ruby Red or Blue Skies	●	●	●	●	●	●	●	□
Wire frame finished in Polished Chrome	●	●	□	□	□	●	□	□
Tubular steel frame finished in Polished Chrome *1	□	□	●	●	●	□	●	□
Plastic glides *2	●	●	□	□	□	●	□	□
Stainless steel self-leveling glides *3	□	□	●	●	●	□	●	□

Optional features:

1. Plastic shell with complementary color on the tubular steel powder coat frame	□	□	+\$80	+\$80	+\$80	□	+\$80	□
2. Plastic glides available with felt	+\$20	+\$20	□	□	□	+\$20	□	□
3. Stainless steel self-leveling glides with felt	□	□	+\$20	+\$20	+\$20	□	+\$20	□
Detachable writing tablet (Specify LH or RH) - Chair does not stack when attached	+\$180	+\$180	□	□	□	□	□	□
Counter height stool option, seat height 24.5" (add CH to product code)	□	□	□	□	+\$72	□	+\$72	□

* Please see pages 216-223 for Textile Finishes & COM Requirements, page 224 for Casper Plastic Finishes & page 238 for available Seating Metal Finishes

dimensions — OH - Overall Height OD - Overall Depth OW - Overall Width AH - Arm Height SH - Seat Height SW - Seat Width SD - Seat Depth

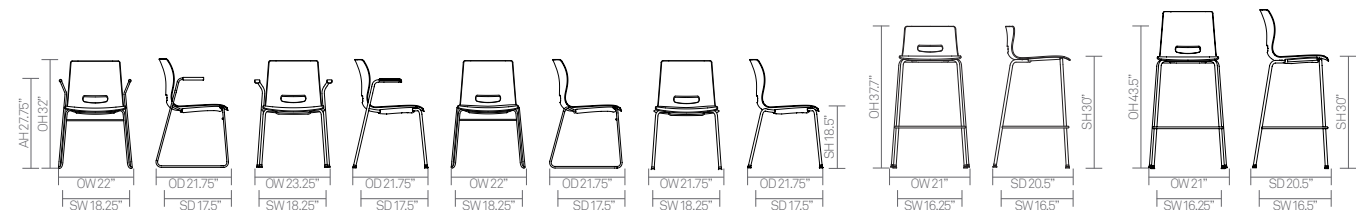

	Plastic	
CS1 • Side chair • Skid base	305	
CS1A • Armchair • Skid base	356	
CS2 • Side chair • 4 leg frame	311	
CS2A • Armchair • 4 leg frame	367	
CS5BS • High stool • Low back • 4 leg frame	411	
CS9BS • High stool • Low back • Skid base	482	
CS7BS • High stool • High back • 4 leg frame	481	
CSTROLLEY • Stacking trolley	1235	

All prices listed in US \$

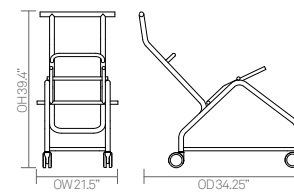

For Instructions on how to specify your item, please see page 75

Casper

Design – Allermuir

Casper is a stylish and contemporary café plastic monoshell chair, with the option of an upholstered seat designed for all manner of hospitality environments in both corporate and leisure markets. Casper is also an ideal meeting chair, due to the added option of a four leg or sled base frame.



standard & optional features

	CS3	CS3A	CS4	CS4A	CS6BS	CS10BS	CS8BS	CSTROLLEY
	Side Chair Skid Base Upholstered	Armchair Skid Base Upholstered	Side Chair 4 Leg Frame Upholstered	Armchair 4 Leg Frame Upholstered	High Stool Low Back 4 Leg Frame Upholstered	High Stool Low Back Skid Base Upholstered	High Stool High Back Skid Base Upholstered	Stacking Trolley
Weight	18lbs	18lbs	15lbs	16lbs	17lbs	21lbs	22lbs	☐
Stacks (on trolley) (fabric may be affected when stacked)	21 high	21 high	15 high	15 high	☐	☐	☐	☐
Plastic shell - Colors: Back to Black, Slate Gray, Smoke Gray, White as Snow, Turtle Dove, Vintage Red, Ruby Red or Blue Skies	●	●	●	●	●	●	●	☐
Wire frame finished in Polished Chrome	●	●	☐	☐	☐	●	☐	☐
Tubular steel frame finished in Polished Chrome *1	☐	☐	●	●	●	☐	●	☐
Upholstered seat	●	●	●	●	●	●	●	☐
Plastic glides *2	●	●	☐	☐	☐	●	☐	☐
Stainless steel self leveling glides *3	☐	☐	●	●	●	☐	●	☐

Optional features:

1. Plastic shell with complementary color on the tubular steel powder coat frame	☐	☐	+\$80	+\$80	+\$80	☐	+\$80	☐
2. Plastic glides available with felt	+\$20	+\$20	☐	☐	☐	+\$20	☐	☐
3. Stainless steel self leveling glides with felt	☐	☐	+\$20	+\$20	+\$20	☐	+\$20	☐
Detachable writing tablet (Specify LH or RH) - Chair does not stack when attached	+\$180	+\$180	☐	☐	☐	☐	☐	☐
Ribbed upholstered seat pad (add P to product code)	+\$30	+\$30	+\$30	+\$30	+\$30	+\$30	+\$30	☐
Counter height stool option, seat height 24.5" (add CH to product code)	☐	☐	☐	☐	+\$72	☐	+\$72	☐

* Please see pages 216-223 for Textile Finishes & COM Requirements, page 224 for Casper Plastic Finishes & page 238 for available Seating Metal Finishes

dimensions— OH - Overall Height OD - Overall Depth OW - Overall Width AH - Arm Height SH - Seat Height SW - Seat Width SD - Seat Depth

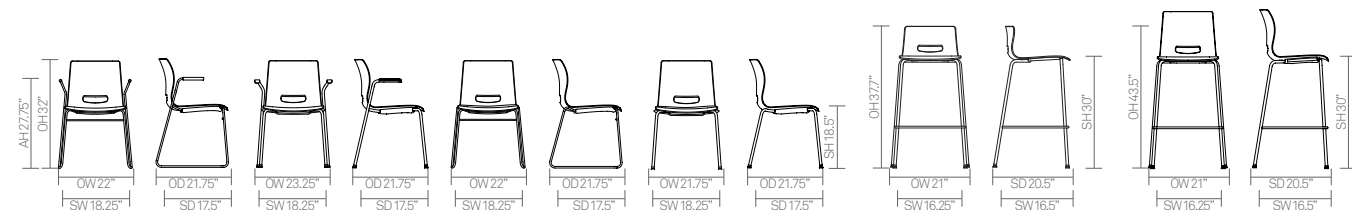

Fabric Grade	C.O.M.		C.O.L.										
	1	2	3	4	5	6	7	8	9	10	11	A	B
CS3 • Side chair • Upholstered seat pad • Skid base	421	434	448	465	482	500	517	551	621	690	759	579	765
	1 yds		22 sq ft.										
CS3A • Armchair • Upholstered seat pad • Skid base	487	499	513	531	548	565	583	617	686	756	825	635	822
	1 yds		22 sq ft.										
CS4 • Side chair • Upholstered seat pad • 4 leg frame	398	410	424	441	459	476	493	528	597	667	736	600	786
	1 yds		22 sq ft.										
CS4A • Armchair • Upholstered seat pad • 4 leg frame	454	466	480	497	514	532	549	584	653	722	791	656	842
	1 yds		22 sq ft.										
CS6BS • High stool • Low back • Upholstered seat pad • 4 leg frame	497	509	523	540	557	575	592	627	696	765	835	700	886
	0.75 yds		16.5 sq ft.										
CS10BS • High stool • Low back • Upholstered seat pad • Skid base	575	587	601	618	635	653	670	704	774	843	912	772	959
	0.75 yds		16.5 sq ft.										
CS8BS • High stool • High back • Upholstered seat pad • 4 leg frame	567	579	593	610	627	645	662	697	766	835	905	770	956
	0.75 yds		16.5 sq ft.										
CSTROLLEY • Stacking trolley	1235												



A, B = Leather

All prices listed in US \$

COM = Customers own Material (yds)

COL = Customers own Leather (sq ft.)

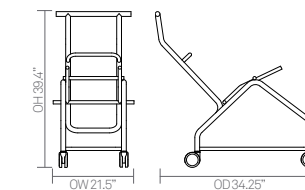

For Instructions on how to specify your item, please see page 75